

## ASSEMBLY INSTRUCTIONS (English)

SKU : 40276

SKU : 37761

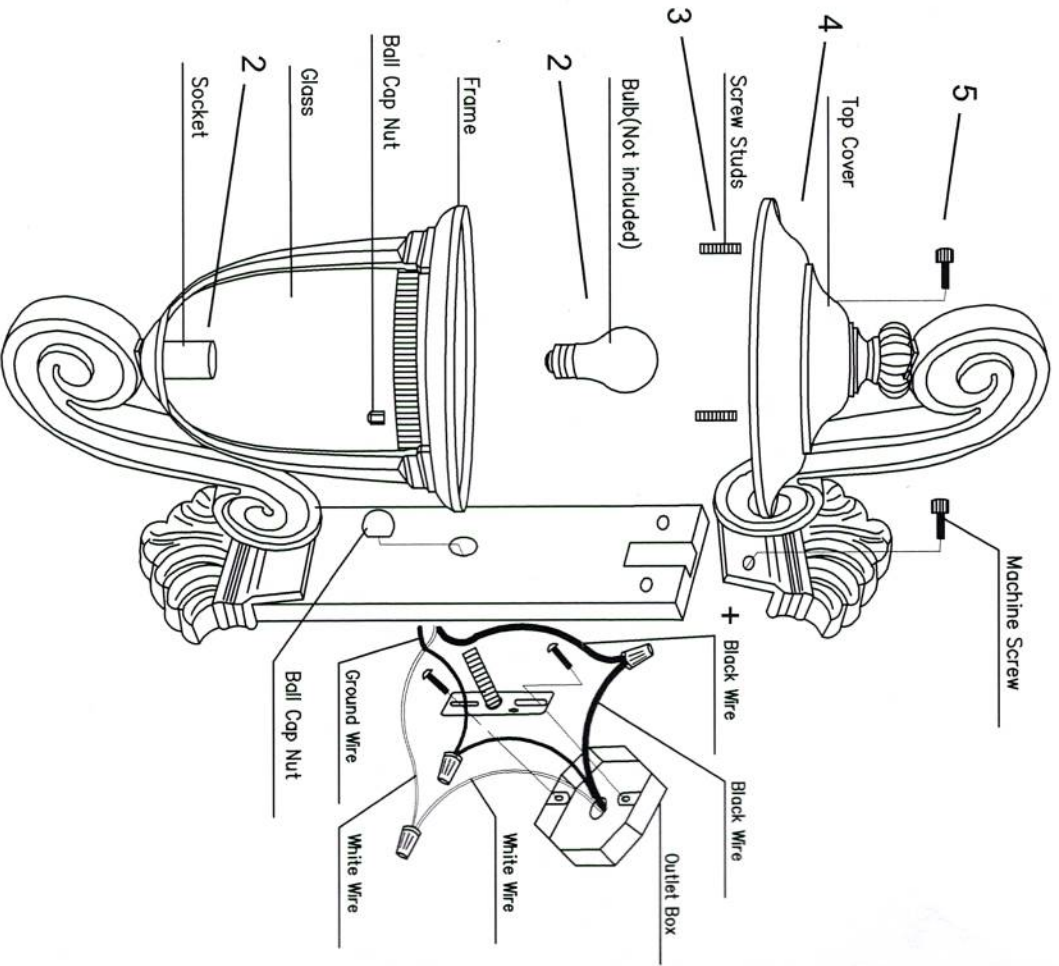

## IMPORTANT

--ALL ELECTRICAL CONNECTION MUST BE IN ACCORDANCE WITH LOCAL CODES, ORDINANCES OR NATIONAL ELECTRICAL CODES. IF YOU ARE UNFAMILIAR WITH QUALIFIED ELECTRICIAN.  
 --BEFORE STARTING INSTALLATION, DISCONNECT THE POWER BY TURNING OFF THE CIRCUIT BREAKER OR BY REMOVING THE FUSE AT THE FUSE BOX.  
 --IMPORTANT SAFEGUARDS AND INSTRUCTIONS APPEARING ON THIS SHEET ARE NOT MEANT TO COVER ALL POSSIBLE CONDITIONS AND SITUATIONS, AND CARE ARE FACTORS WHICH MUST BE SUPPLIED BY THE PERSON(S) CARING FOR AND OPERATION THE UNIT.

1. Carefully unpack and identify all parts.
2. Put the drivepipe in the socket then screw the bulb in it.
3. Fix the thread onto the frame.
4. put the cover on the frame.
5. Screw the top cover with two decorative nuts.
6. Make wire connection: Refer to chart below for correct connection. Wire supply wires to fixture wires accordingly.

Connect Black or Supply Wire to:	Connect White Supply Wire to :
Black Fixture Wire or *parallel cord (Round & smooth)	White Fixture Wire or *parallel cord (Square & Ridged)
Clear, Brown, Glod or Black Without tracer	Clear, Brown, Glod or Black Without tracer
Insulated wire (Other than green) With copper Conductor	Insulated wire (Other than green)

Note: when parallel wire (SPT1&SPT2), is used. One wire is square shaped or ridged and the other wire will be round is smooth (See Illustration)

